

# ASSEMBLY INSTRUCTIONS ekey home (net) integra

## NOTE ON THE DOCUMENT

These assembly instructions as well as the additional information and instructions on the supplied DVD are not subject to updating. You can find the most up to date version of these documents at [www.ekey.net](http://www.ekey.net). Subject to optical and technical amendments, as well as printing and typing errors

### WARNING !

Please also observe the information on the supplied DVD as well as these instructions.

## DELIVERY CONTENTS

FINGERSCANNER CONTROL UNIT POWER ADAPTOR ASSEMBLY INSTRUCTIONS



4 X DOWELS S5

2 X SCREWS SNK 4.0X35

2X SCREWS LK 2.9 X 38

DIN RAIL DIN RAIL 35MM X

DECORATIVE ELEMENT



## ASSEMBLY OF THE EKEY HOME (NET) INTEGRA – FINGERPRINT SCANNER

### MOUNTING HEIGHT

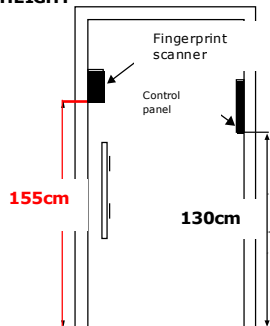

The specified mounting height is 155cm or higher!

Only by mounting the device at the correct height can guarantee good operation and thereby flawless functioning!

Before you mount the fingerprint scanner and control panel, a counter-sinking in the door leaf or door frame is necessary.

During installation please make sure that there is a space of approx. one hand's width on both sides of the fingerprint scanner, in order to guarantee that the device functions without a problem.



### COUNTER-SINK

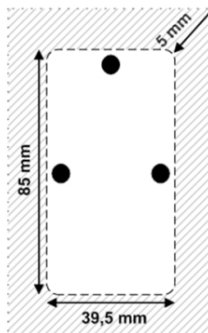

Stellen Sie in Ihrem Türprofil oder in der Holztür eine Ausfräsung mit unten stehenden Abmessungen her.

Cut out your door profile or timber door according to the measurements below.

Frästiefe bei Holztüren

Cutout depth on timber doors



\* empfohlene Fräsmasse (können je nach Werkstoff variieren) Maße in mm – Toleranz ± 0,2 mm

\* Recommended cutout measures (vary depending on the material) Measures in mm – tolerance ± 0,2 mm

### MOUNTING IN TIMBER DOOR LEAF

Entfernen Sie die 3 Schrauben samt den Klemmhasen

Remove the 3 screws together with the edge clamps

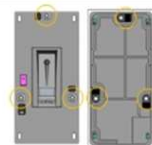

Verwenden Sie bitte die mitgelieferten Schrauben direkt zur Befestigung im Holz

Please use the supplied screws for timber mounting

Holz Türblatt mit passender Ausfräsung für ekey Fingerscanner integra

Timber door leaf with convenient cutout for ekey integra finger scanner

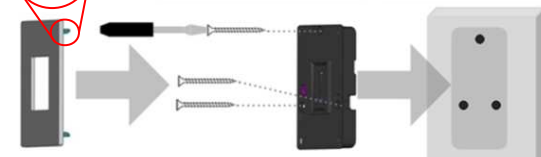

### MOUNTING IN PROFILE, FRONTPLATE, CONTROL BOARD

Mit Schraubendreher Schrauben anziehen bis ekey FS IN fest sitzt (**ACHTUNG** nicht zu fest anziehen, Gehäuse des ekey FS IN könnte zerstört werden)

Use a screwdriver to tighten the screws until the ekey FS IN is mounted tightly (**BEWARE:** do not tighten the screws too much, you could damage the ekey FS IN housing!)

Profil, Frontplatte oder Schalttafel mit Ausfräsung für ekey FS IN

Profile, front plate or control board with cutout for ekey FS IN

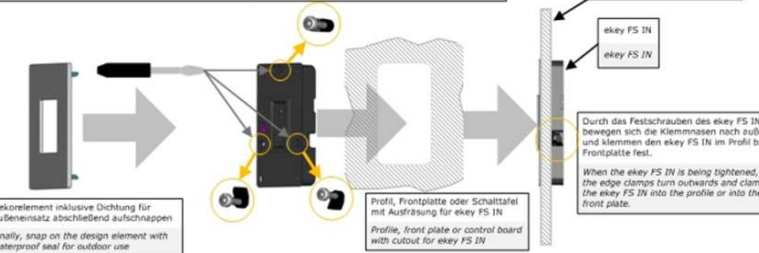

Dezoretemet inklusive Dichtung für Außenansatz abschließend aufschneiden

Finally, snap on the design element with waterproof seal for outdoor use

Profil, Frontplatte oder Schalttafel mit Ausfräsung für ekey FS IN

Profile, front plate or control board with cutout for ekey FS IN

Durch das Festschrauben des ekey FS IN bewegen sich die Klemmhasen nach außen und klemmen den ekey FS IN im Profil bzw. Frontplatte fest.

When the ekey FS IN is being tightened, the edge clamps turn outwards and clamp the ekey FS IN into the profile or into the front plate.

## EKEY HOME (NET) CONTROL PANEL – WALL MOUNTING

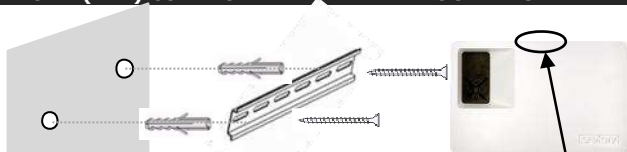

**Tab** for detaching the casing lid  
Lift the tab lightly and pull the lid up. This is necessary for the wiring of the system

First install the mounting rail (DIN rail 35mm). The control panel is then locked onto the mounting rail.  
You can, of course, also mount the control panel in a control cabinet on a standard – 35mm DIN rail.

## ELECTRICAL WIRING

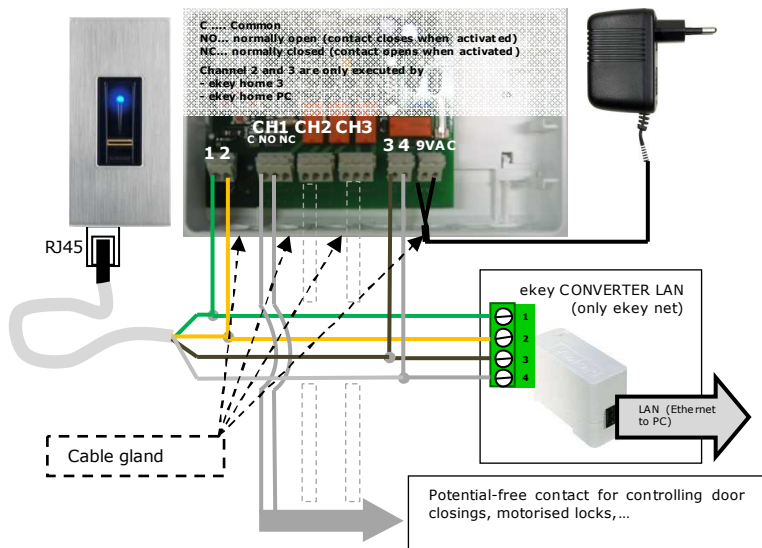

## PIN Assignment- ekey Fingerscanner integra

| Pin Assignment- RJ45                            | PIN | Cable color |
|---|-----|-------------|
| RS485 (TERMINAL 1)                              | 4   | green       |
| RS485 (TERMINAL 2)                              | 5   | yellow      |
| Power supply to fingerprt. scanner (TERMINAL 3) | 7   | brown       |
| Power supply to fingerprt. scanner (TERMINAL 4) | 8   | white       |



**Attention:** cable colors are only valid by using cable Typ A from ekey biometric systems.

## TECHNICAL DATA

| Technical data ekey home (net) fingerprint scanner integra | Unit              | ekey home integra ekey net integra |
|--|-------------------|------------------------------------|
| Power supply   | V AC              | 8-24                               |
|  | V DC              | 8-30                               |
| Power input  | W                 | approx. 1                          |
| Temperature range  | °C                | -25 to +70                         |
| Memory   | Fingerpts         | home: 99                           |
|  |                   | net: 40/200/2000                   |
| Security   | FAR               | 1x 10 <sup>-6</sup>                |
|  | FRR               | 1.4x 10 <sup>-2</sup>              |
| Protection class   | IP                | 54 (front)                         |
| Speed  | S                 | 1-4                                |
| Life cycle   | Fingerprint scans | ca. 10 mill.                       |

The control panel and the fingerprint scanner must be connected with a 4-core cable which has a core diameter of 0.14mm<sup>2</sup>. For distances of over 50m a cable has to be selected with a larger

| Technical data ekey home (net) control panel | Unit             | ekey home          | ekey home 3, pc ekey net |
|--|------------------|--------------------|--------------------------|
| Power supply                                 | V A/C            | 9-12               | 9-12                     |
|  | V D/C            | 9-12               | 9-12                     |
| Power input                                  | W                | approx. 2          | approx. 2                |
| Relays                                       | Number           | 1                  | 3                        |
| Switching capacity of the relays             |                  | 230V AC / 5A       | 230V AC / 5A             |
| Mechanical life span of the relays           | Switching cycles | 10 mill.           | 10 mill.                 |
| Electrical life span of the relay *          | Switching cycles | 200,000 at 250V/5A | 200,000 at 250V/5A       |
| Temperature range                            | °C               | -20 to +70         | -20 to +70               |
| Protection class                             | IP               | 40                 | 40                       |
| Digital inputs                               |                  | -                  | -                        |

core diameter for the live cores (connections 3 and 4). The maximum cable length between the fingerprint scanner and the control panel is 500m.

The connection cable between the control panel and the fingerprint scanner is to be laid separately from the electrical installations of the building, as these signals produce a low-voltage area which can be impaired by adjacent live cables.

**The connections do not have reverse polarity protection! An incorrect electrical connection of the system can cause damage to the device.**  
**The creation of the electrical connection and the connection to the mains can only be carried out by specialists!**